

N° LP: **1**

Nom: **Aretier a dever**  
 Quantité: **1**  
 Groupe:  
 Sous-groupe:

Section: 58mm/170mm  
 Longueur: 1488mm  
 Matériaux: Sapin

Date: 18.03.2017  
 Projet:  
 Poids: 7 kg

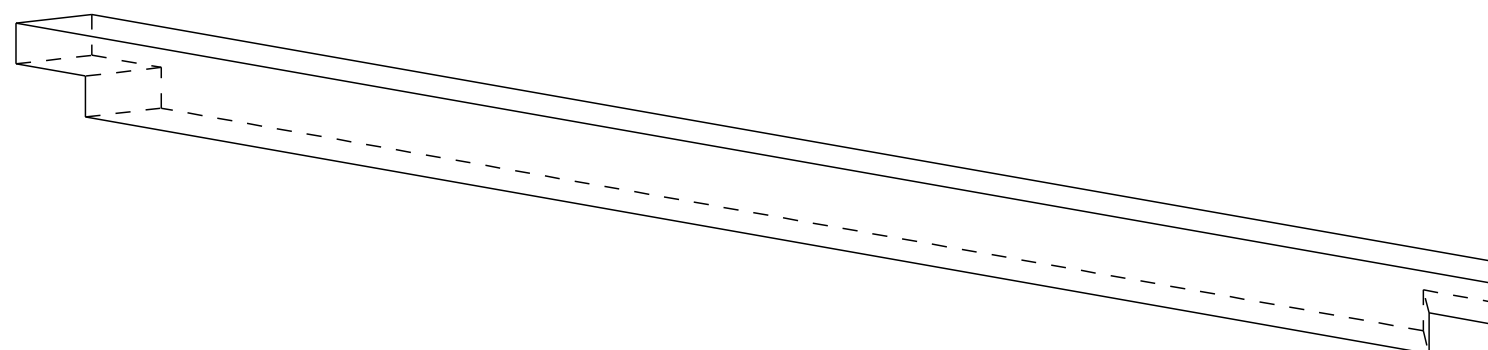
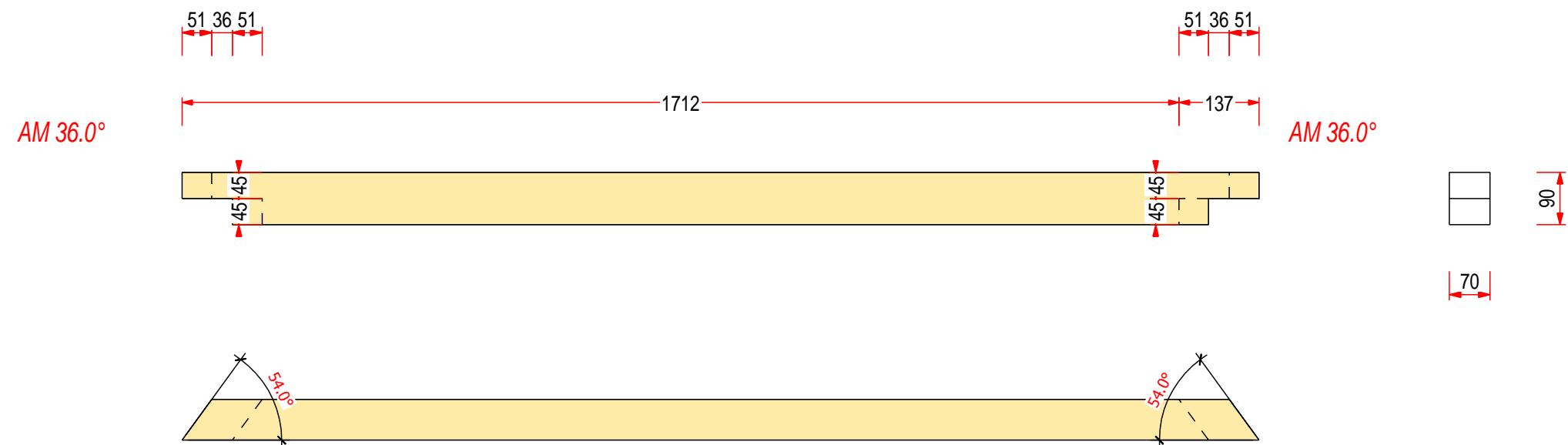

N° LP: **2**

Nom: **Entrait**  
Quantité: **1**

Groupe: Ensemble dao  
Sous-groupe:

Section: 70mm/90mm  
Longueur: 1850mm  
Matériaux: Chêne

Date: 18.03.2017  
Projet:  
Poids: 9 kg

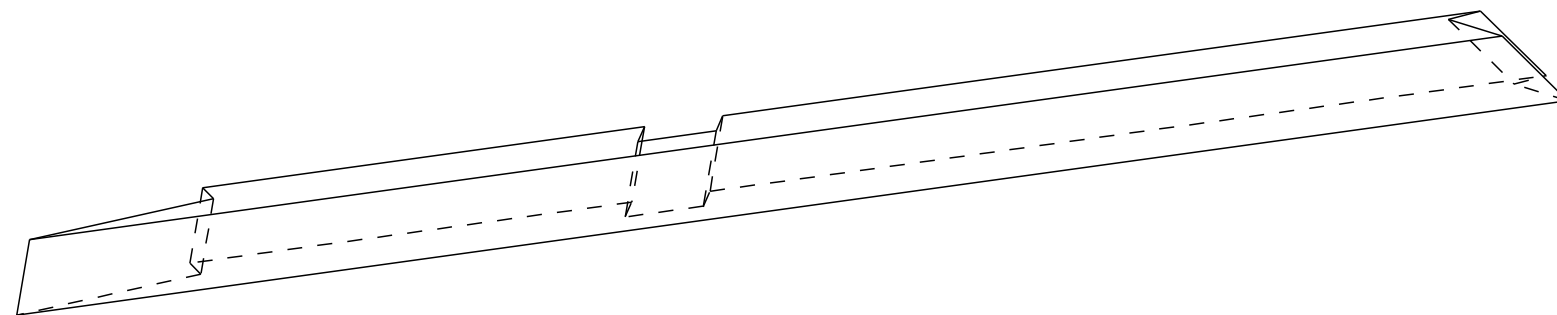
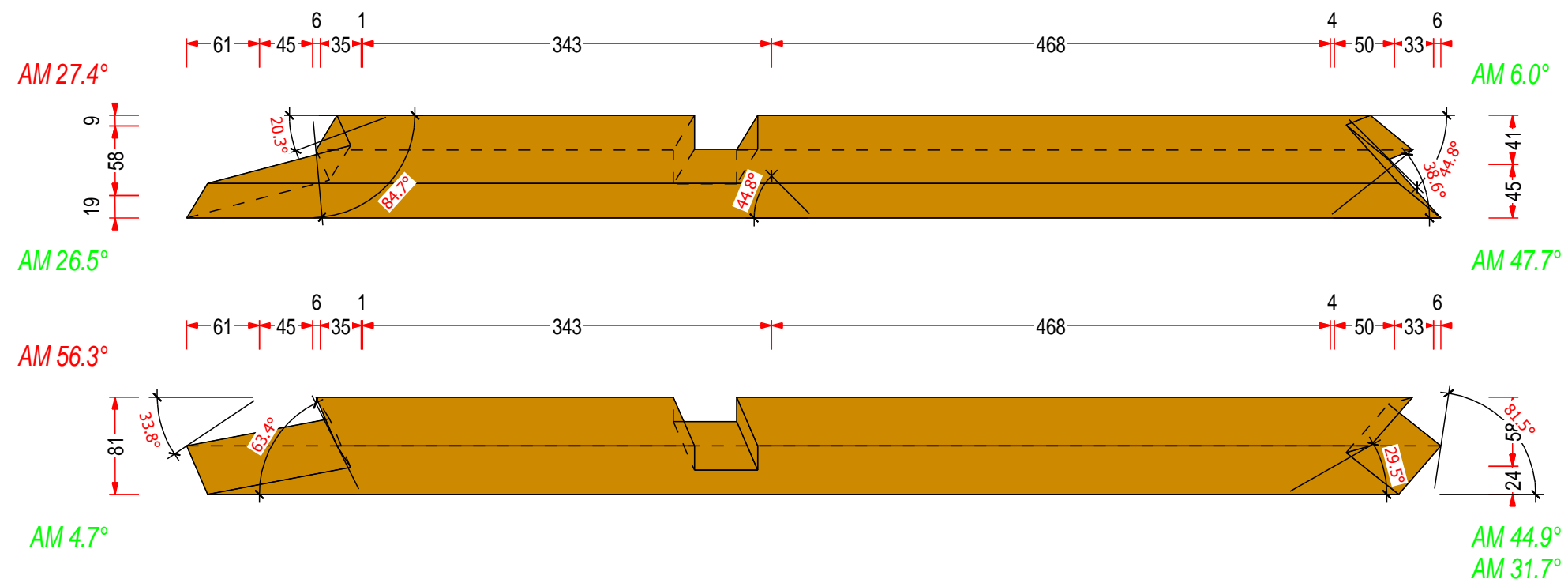

N° LP: **3**

Nom: **Croix**  
Quantité: **1**

Groupe: Ensemble Epure  
Sous-groupe:

Section: 81mm/86mm  
Longueur: 1051mm  
Matériaux: Sapin

Date: 18.03.2017  
Projet:  
Poids: 2 kg

cadwork®

AM 12.0°

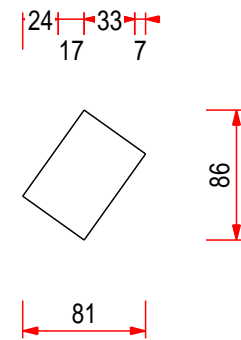
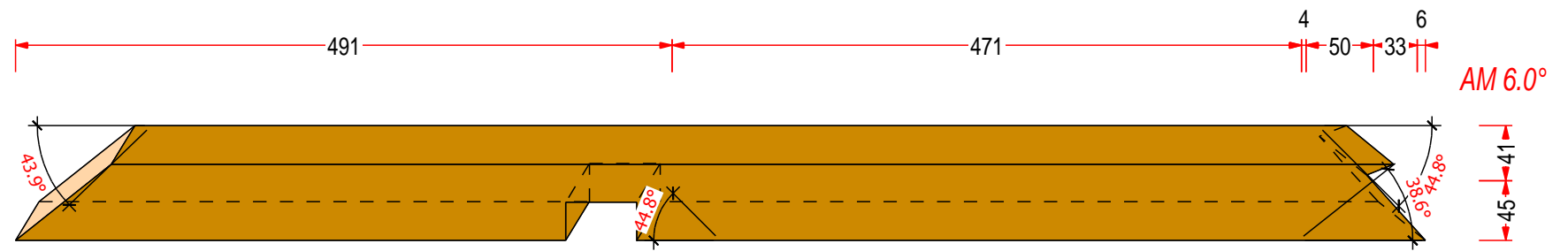

AM 44.8°

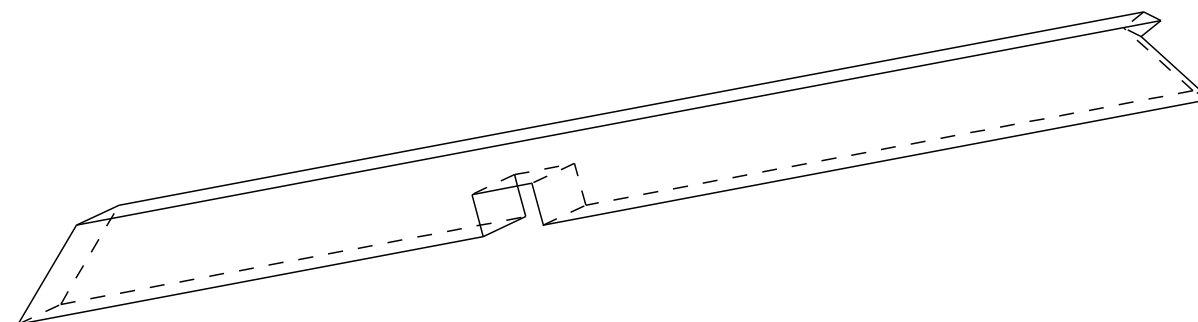
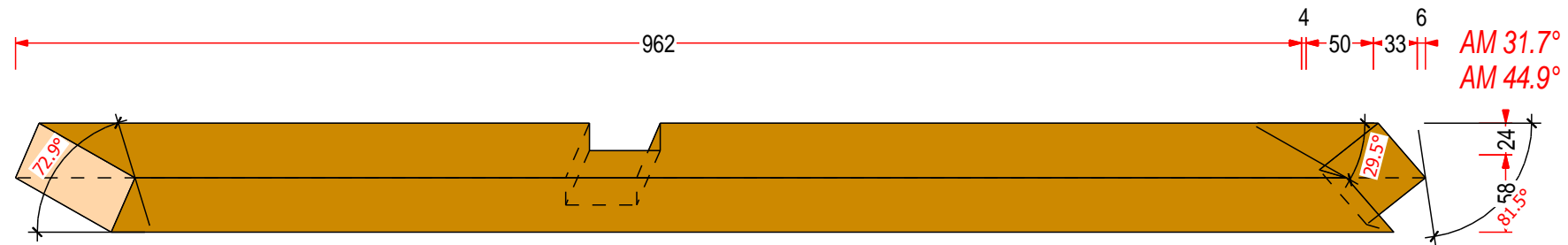

N° LP: **4**

Nom: **Croix**  
Quantité: **1**

Groupe: Ensemble Epure  
Sous-groupe:

Section: 81mm/86mm  
Longueur: 1055mm  
Matériaux: Sapin

Date: 18.03.2017  
Projet:  
Poids: 2 kg

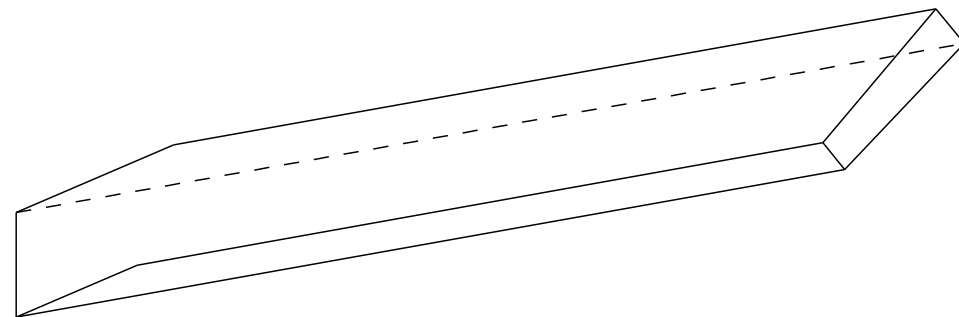
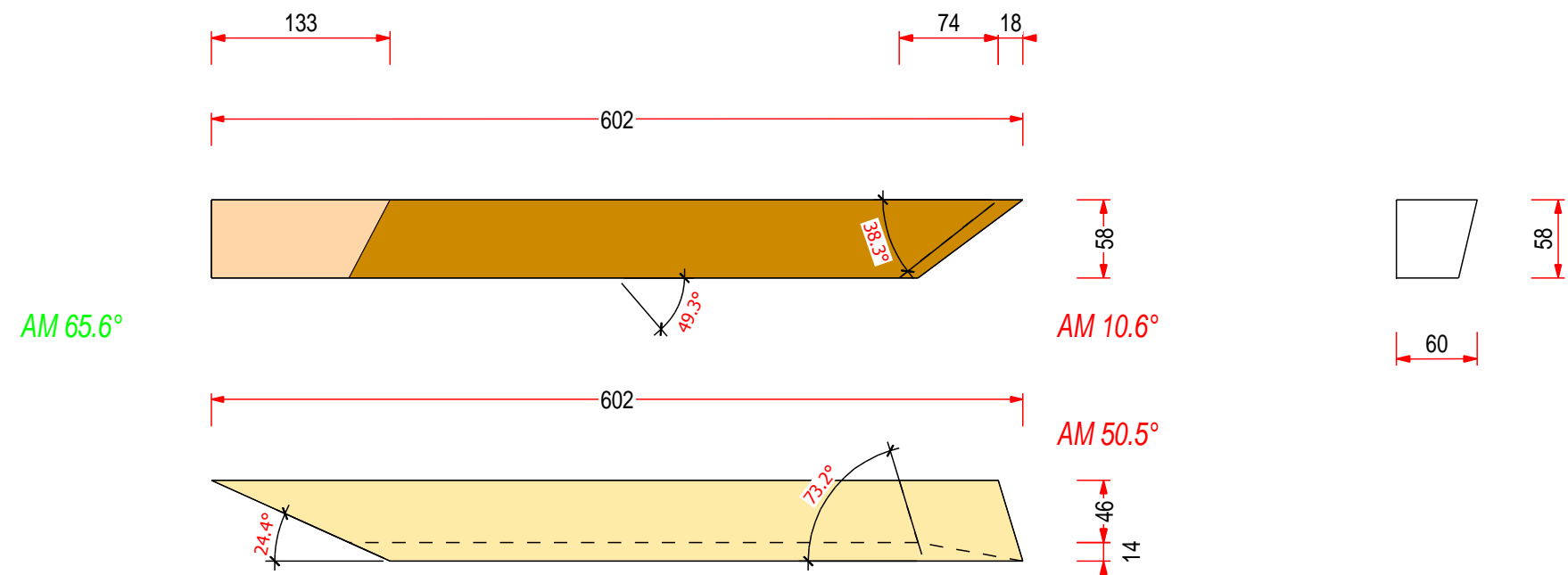

N° LP: **5**

Nom: **Noulet**  
Quantité: **1**

Groupe: Ensemble Epure  
Sous-groupe:

Section: 60mm/58mm  
Longueur: 602mm  
Matériaux: Sapin

Date: 18.03.2017  
Projet:  
Poids: 1 kg

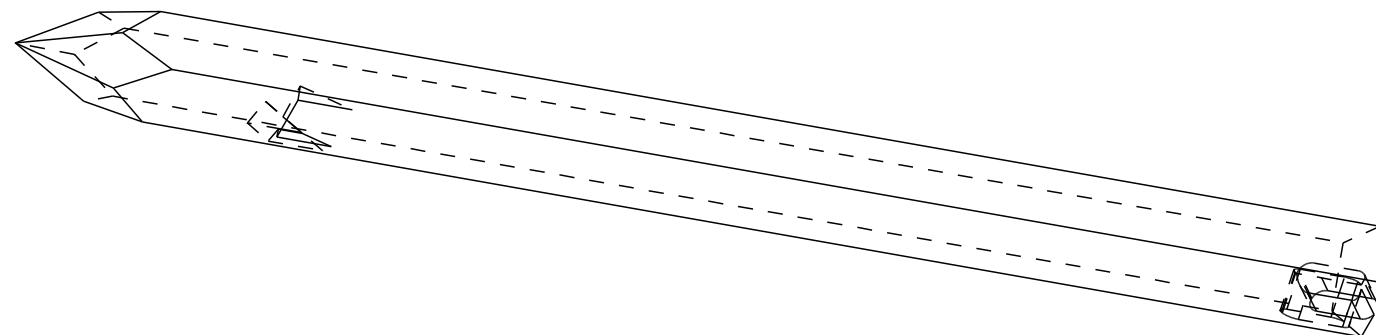
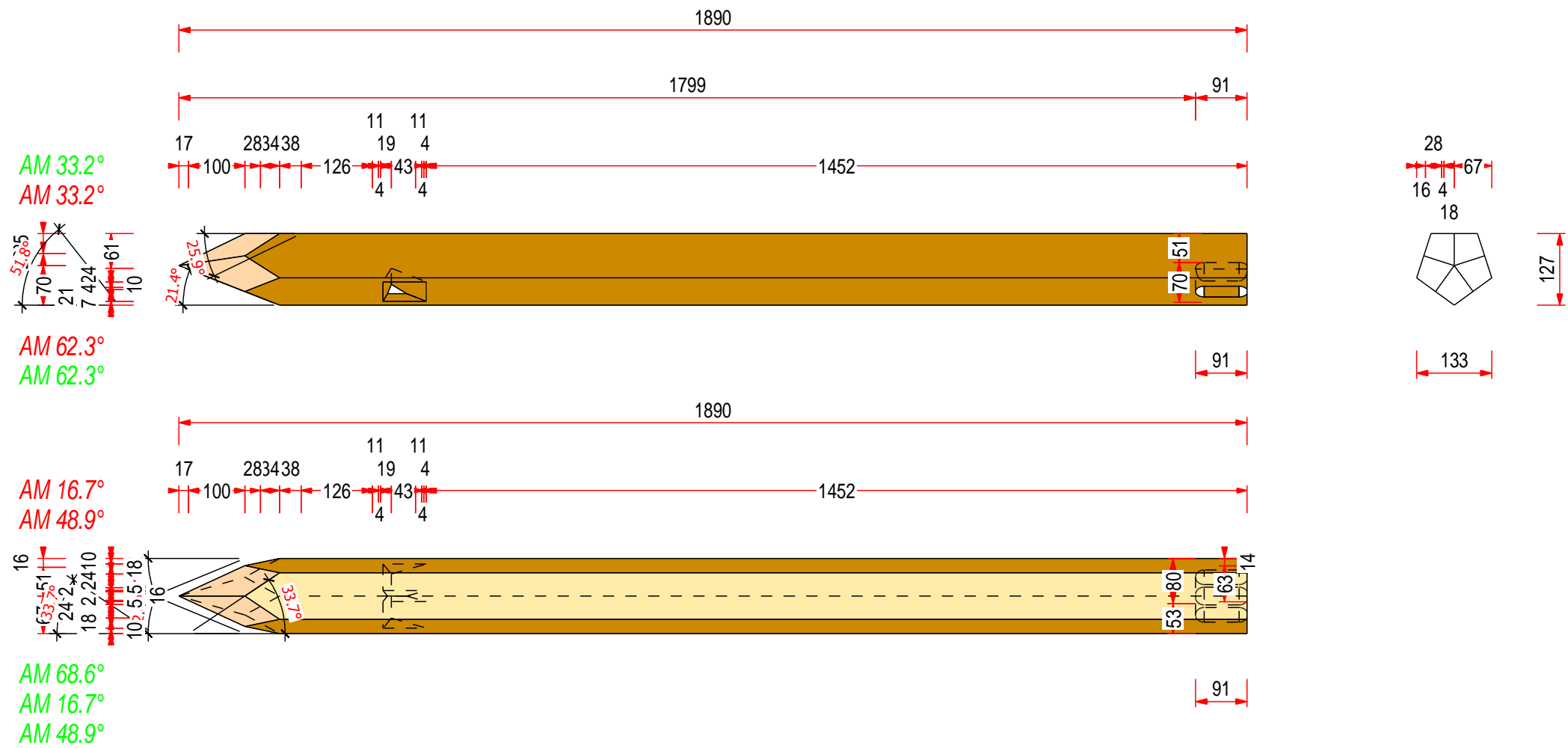

N° LP: **6**

Nom: **Poincon**  
Quantité: **1**

Groupe:  
Sous-groupe:

Section: 133mm/127mm  
Longueur: 1890mm  
Matériaux: Sapin

Date: 18.03.2017  
Projet:  
Poids: 11 kg

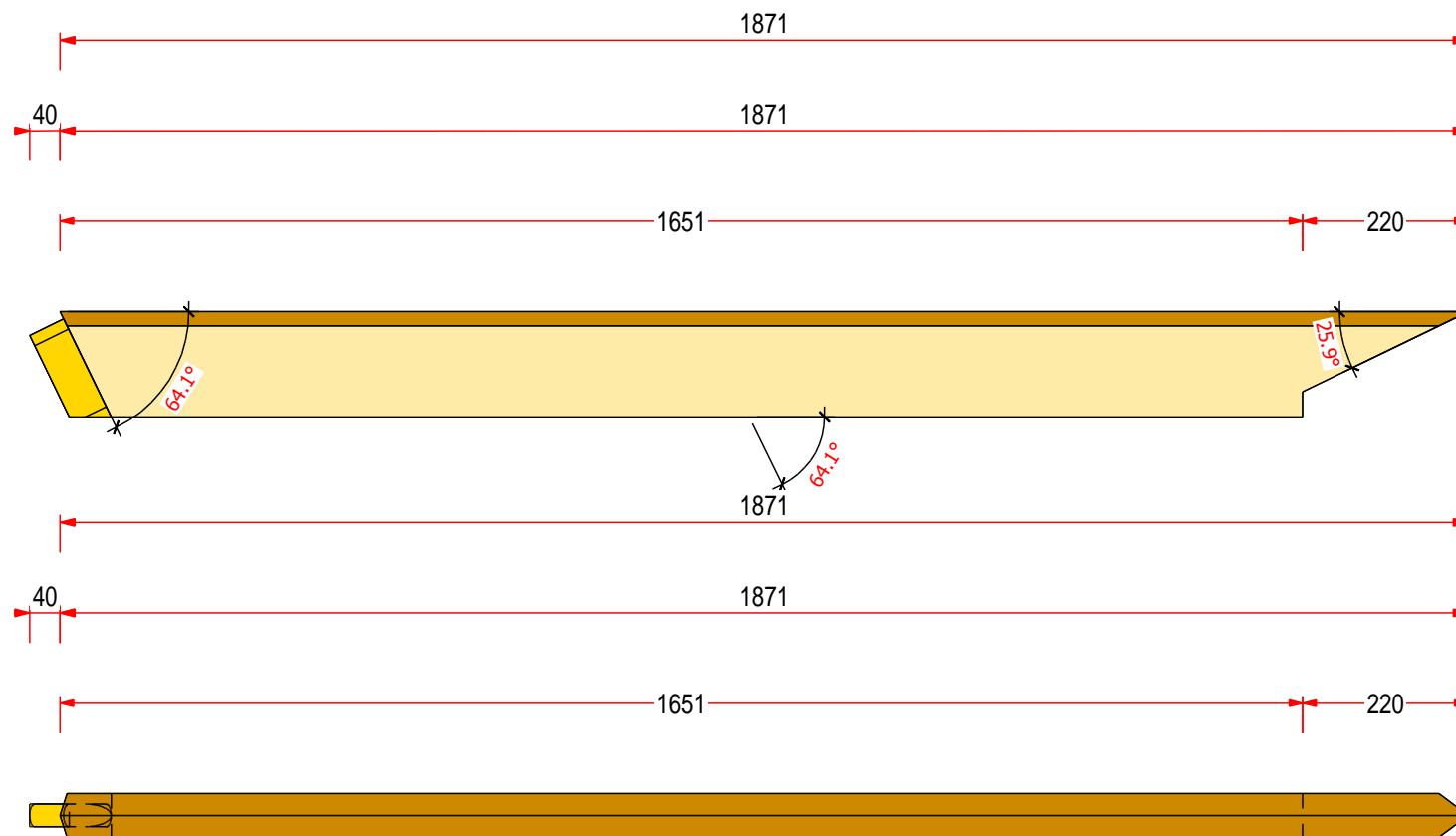

AM 25.9°

AM 64.1°

<b>Tenon 1</b>	
tenon-70-40-L	
Forme	rond
Direction	Largeur
Longueur	50mm
Surlongueur	2mm
Largeur	30mm
Surmesure mortaise	1mm
ø percement	0mm
Ecartement perçage-extrémité	0mm
Décalage perçage	0mm

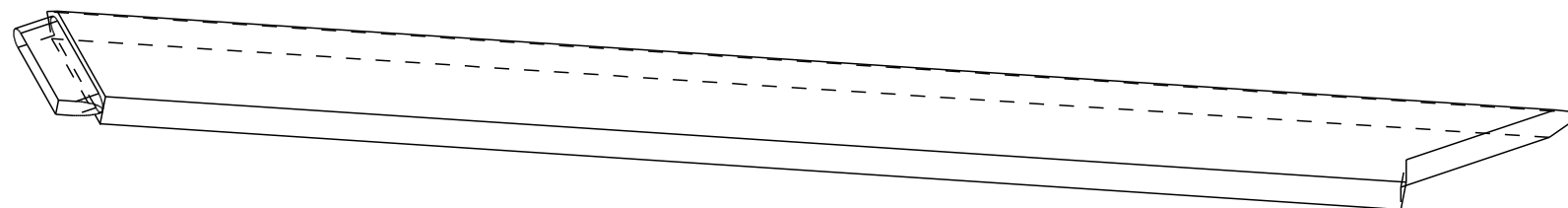

N° LP: **7**

Nom: **Aretier flèche**  
Quantité: **1**  
Groupe:  
Sous-groupe:

Section: 58mm/140mm  
Longueur: 1911mm  
Matériaux: Chêne

Date: 18.03.2017  
Projet:  
Poids: 10 kg

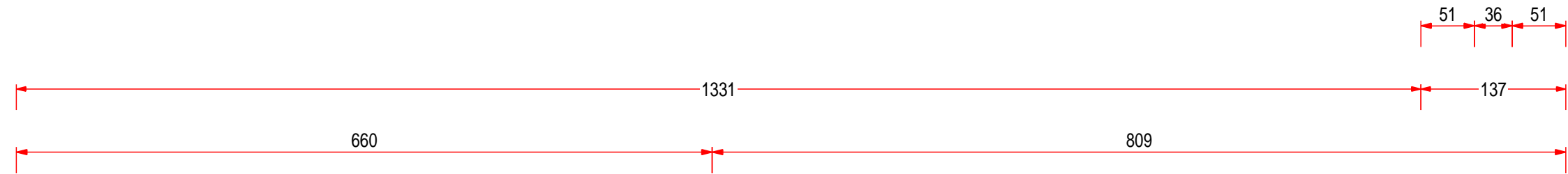

AM 36.0°

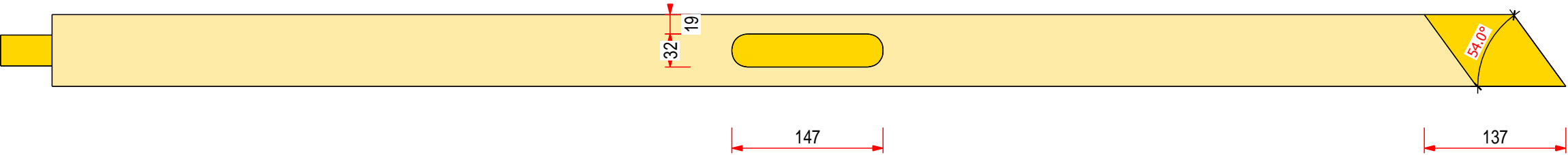
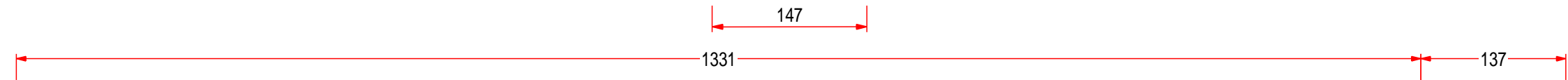
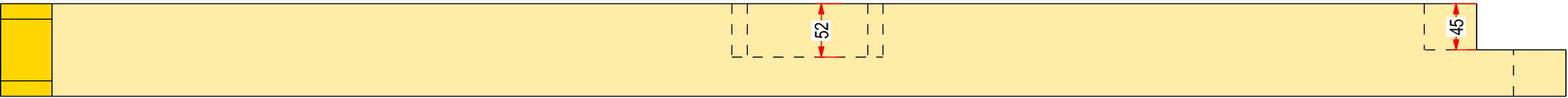

**Tenon 1**

tenon-70-40-L

Forme	rond
Direction	Largeur
Longueur	50mm
Surlongueur	2mm
Largeur	30mm
Surmesure mortaise	1mm
ø percement	0mm
Ecartement perçage-extrémité	0mm
Décalage perçage	0mm

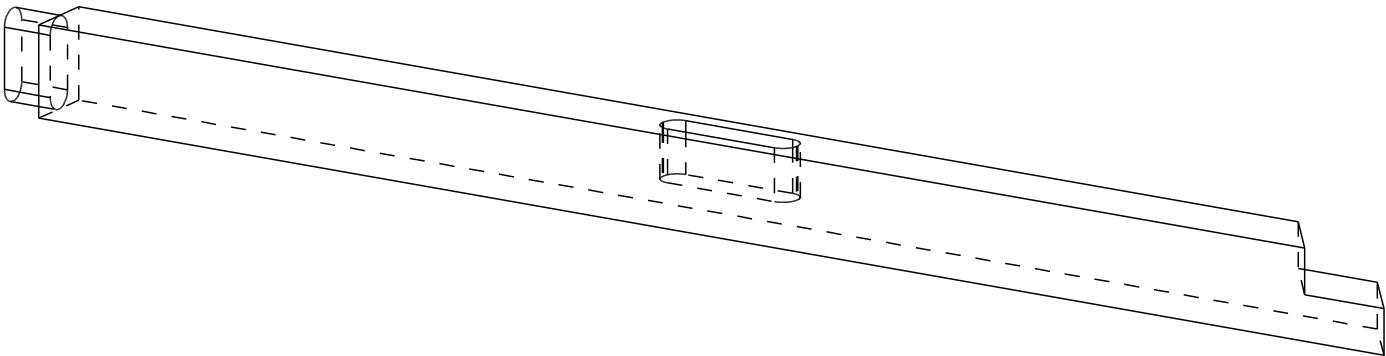

N° LP: **8**

Nom: **Entrait**  
Quantité: **1**

Groupe: Ensemble dao  
Sous-groupe:

Section: 70mm/90mm  
Longueur: 1519mm  
Matériaux: Chêne

Date: 18.03.2017  
Projet:  
Poids: 7 kg

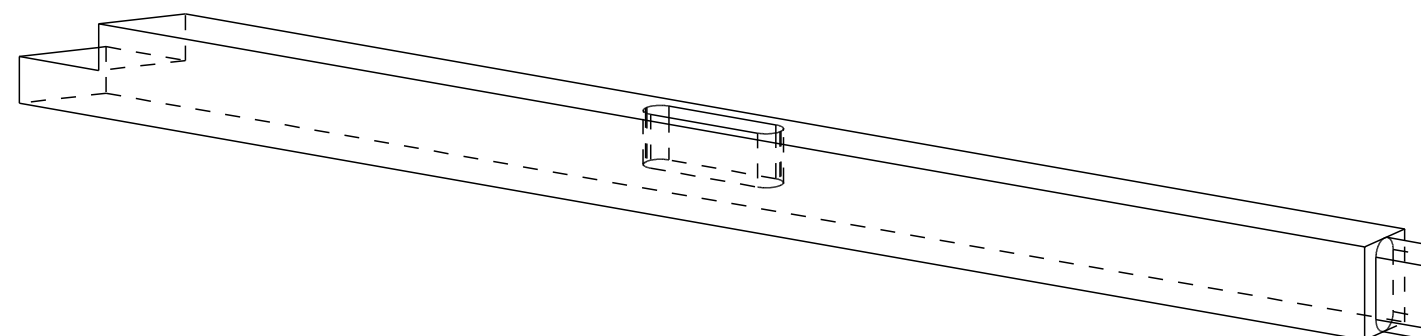
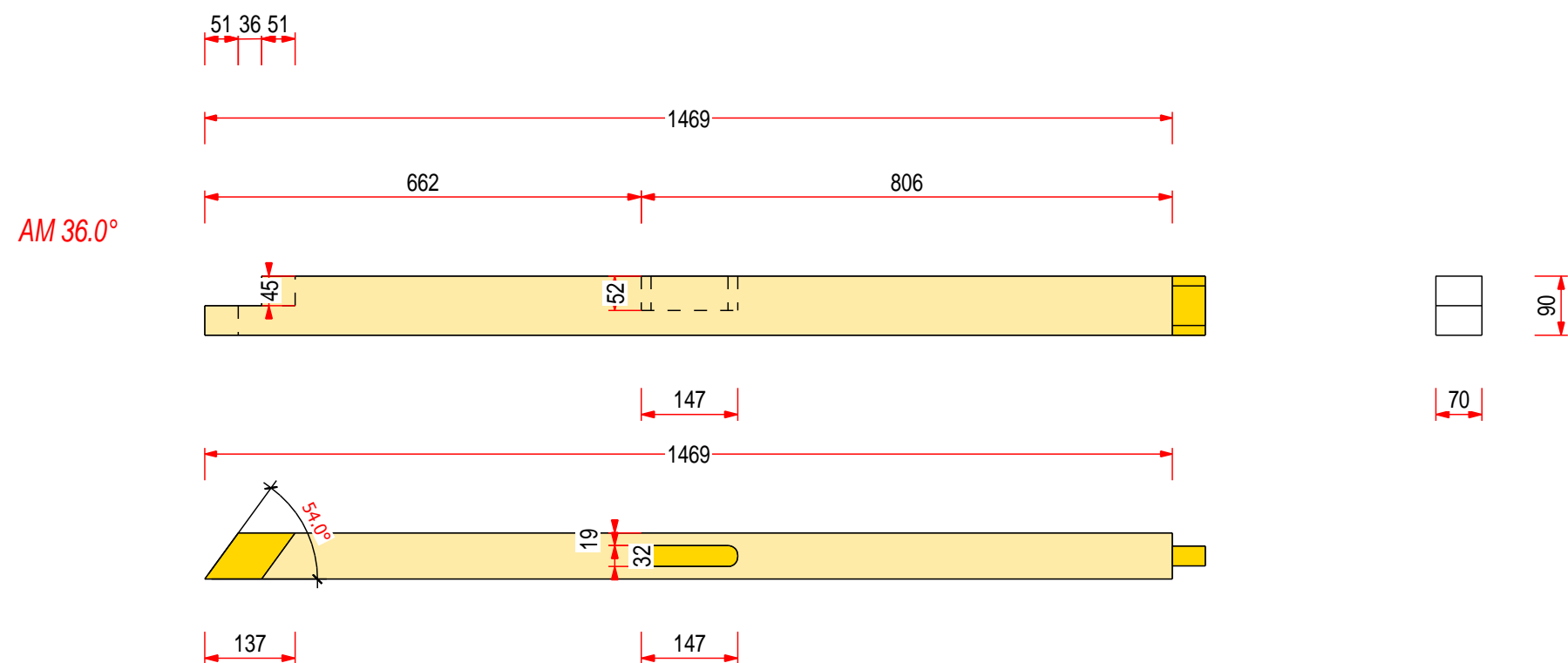

**Tenon 1**

tenon-70-40-L	
Forme	rond
Direction	Largeur
Longueur	50mm
Sur longueur	2mm
Largeur	30mm
Sur mesure mortaise	1mm
ø percement	0mm
Ecartement perçage-extrémité	0mm
Décalage perçage	0mm

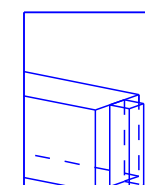

N° LP: **9**

Nom: **Entrait**  
Quantité: **1**

Groupe: Ensemble dao  
Sous-groupe:

Section: 70mm/90mm  
Longueur: 1519mm  
Matériaux: Chêne

Date: 18.03.2017  
Projet:  
Poids: 7 kg

**caadwork**



AM 27.0°

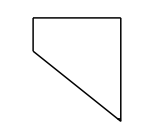
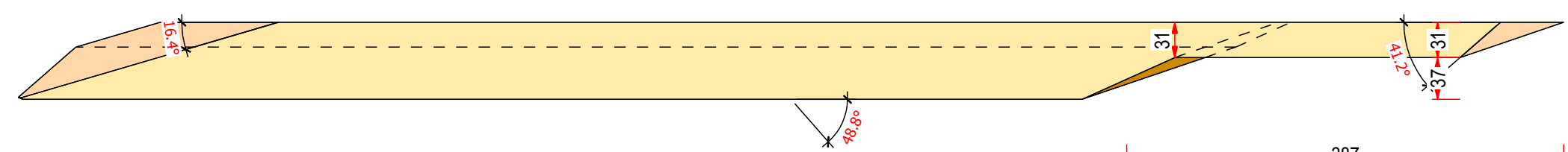
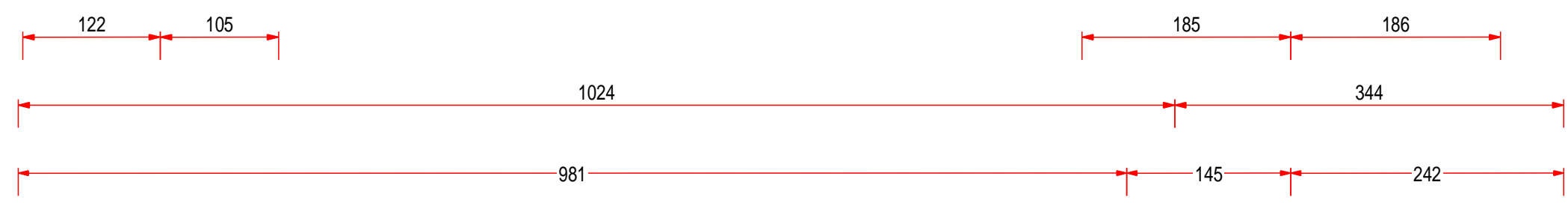

68

AM 43.3°

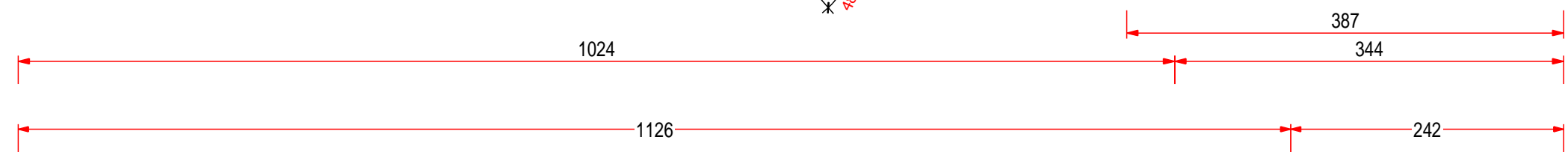

58

AM 58.8°

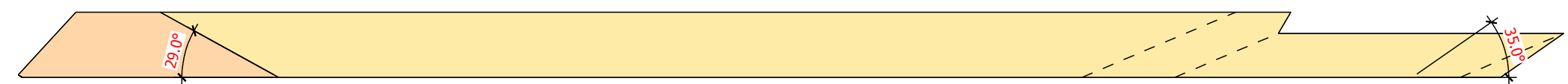

AM 33.2°

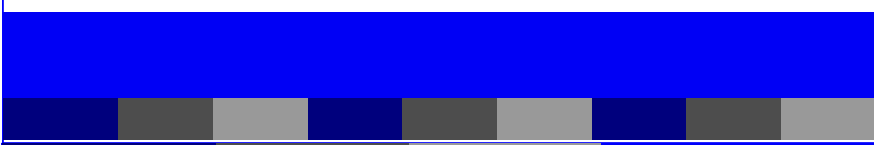
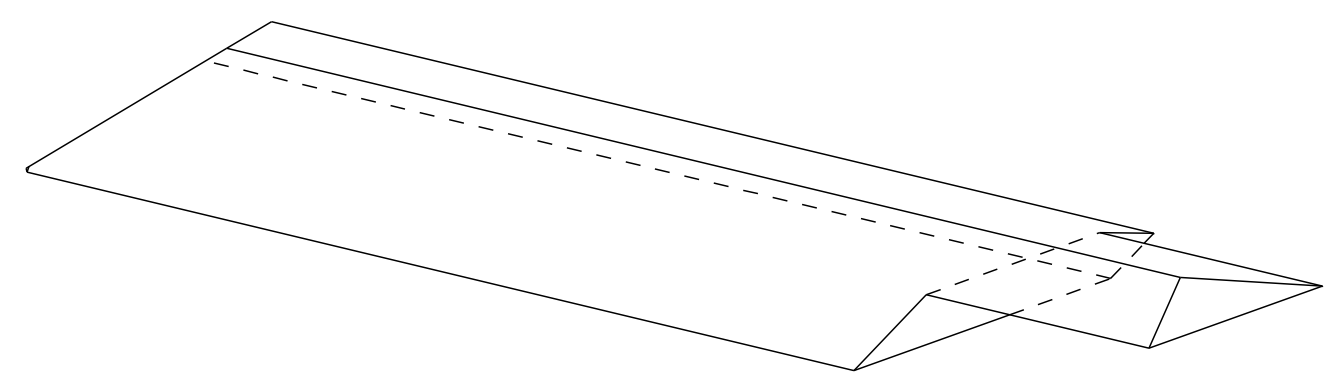

N° LP: 10

Nom: Chanlatte  
Quantité: 1

Groupe: Ensemble Epure  
Sous-groupe:

Section: 58mm/68mm  
Longueur: 1368mm  
Matériaux: Sapin

Date: 18.03.2017  
Projet:  
Poids: 1 kg

cadwork®

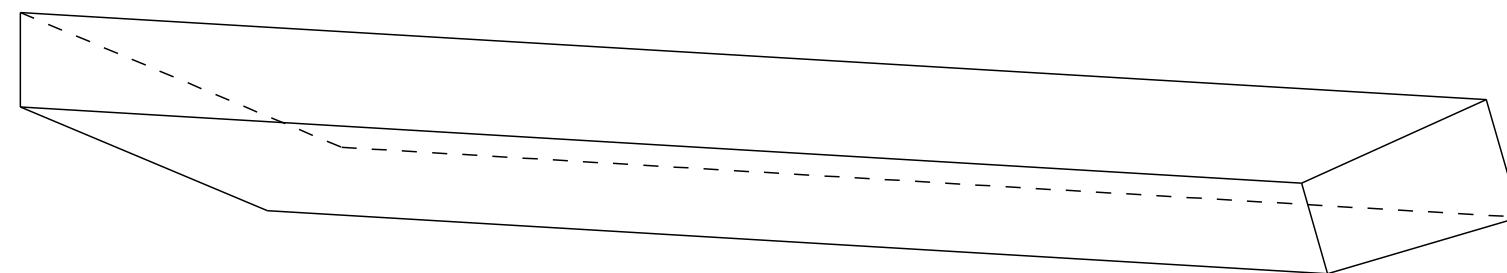
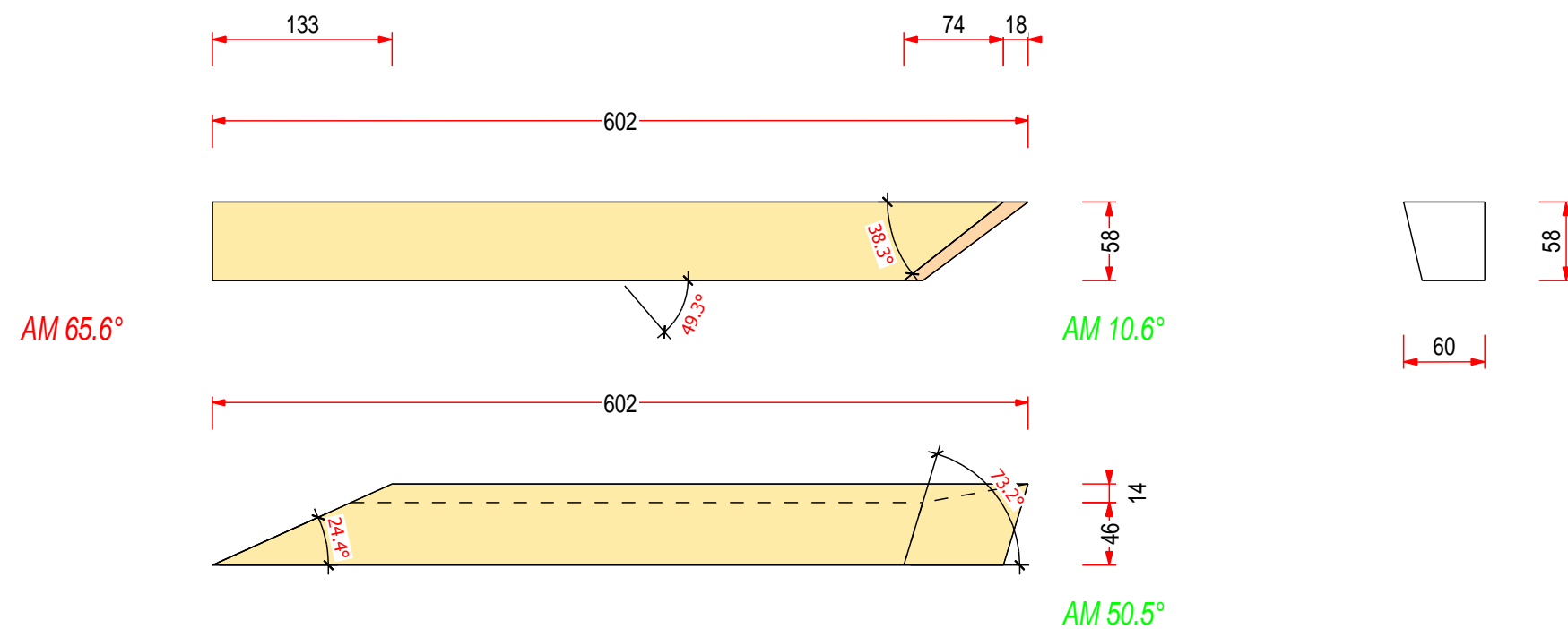

N° LP: **11**

Nom: **Noulet**  
Quantité: **1**

Groupe: Ensemble Epure  
Sous-groupe:

Section: 60mm/58mm  
Longueur: 602mm  
Matériaux: Sapin

Date: 18.03.2017  
Projet:  
Poids: 1 kg

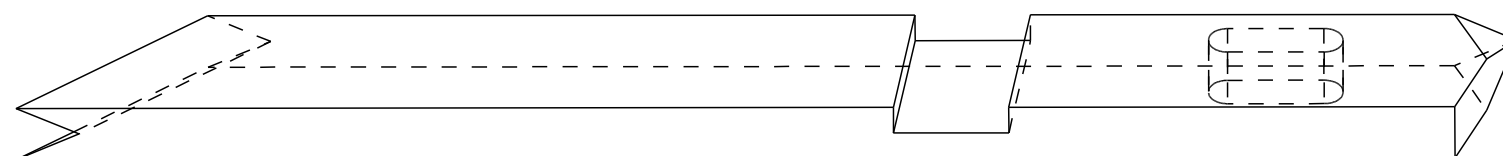
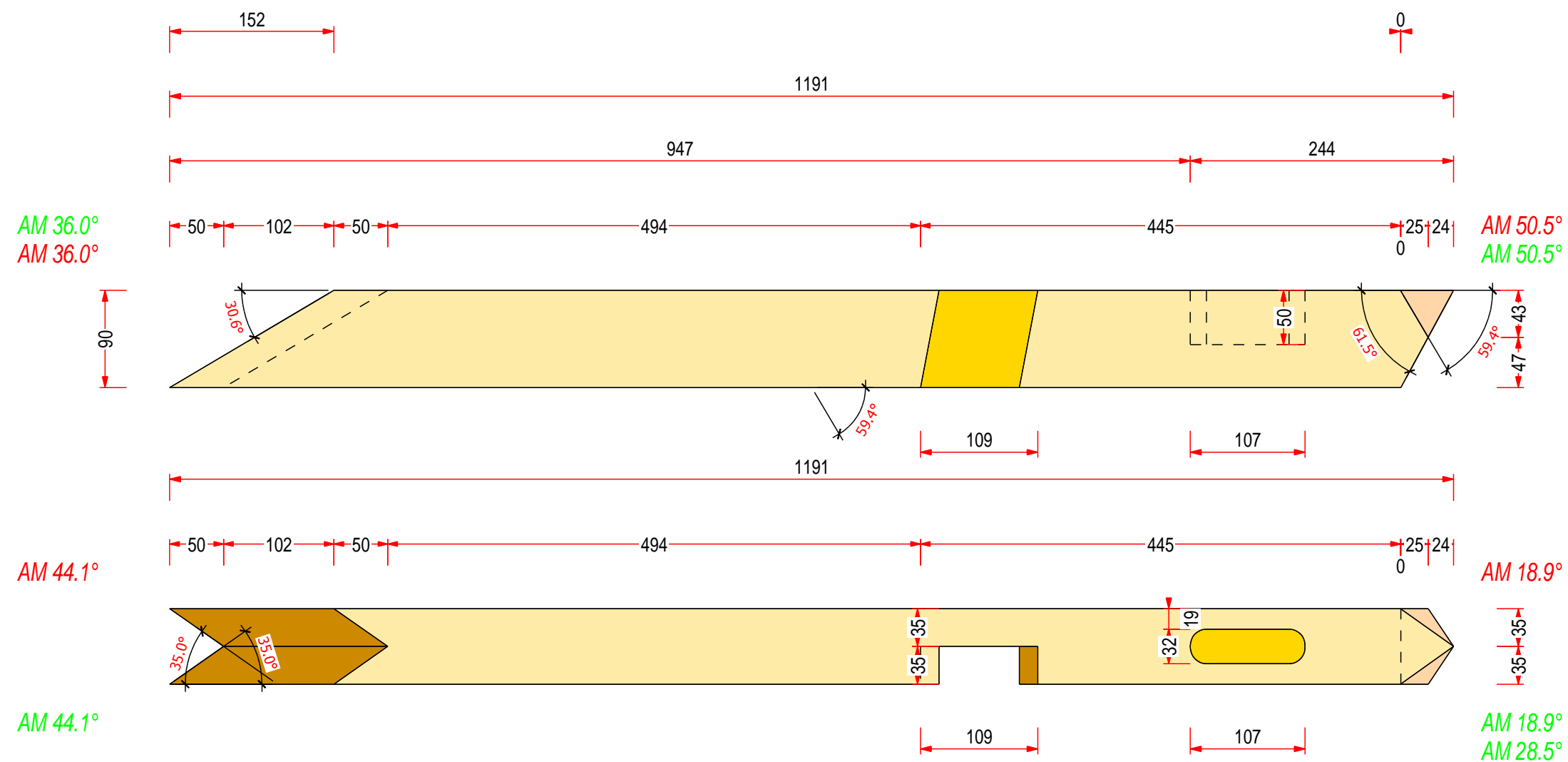

N° LP: **12**

Nom: **Poinçon incliné**  
 Quantité: **1**  
 Groupe:  
 Sous-groupe:

Section: 70mm/90mm  
 Longueur: 1191mm  
 Matériaux: Chêne

Date: 18.03.2017  
 Projet:  
 Poids: 5 kg

caadwork®

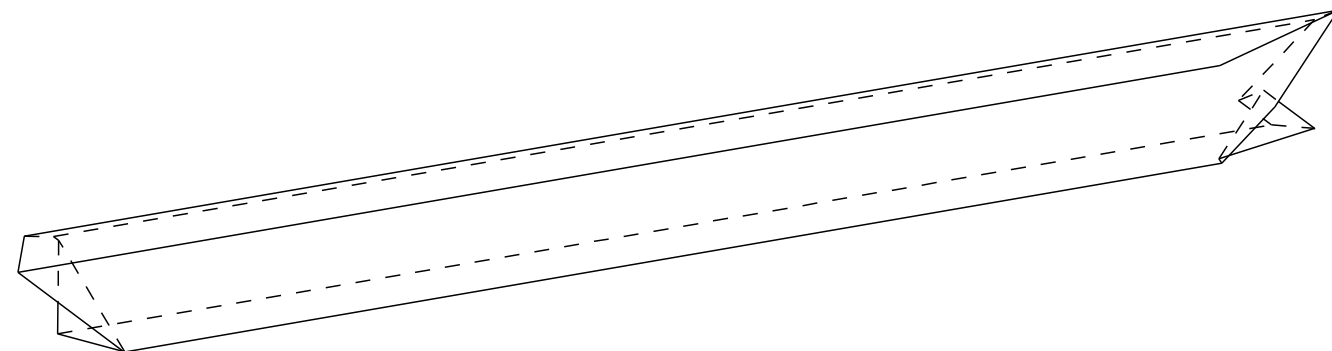
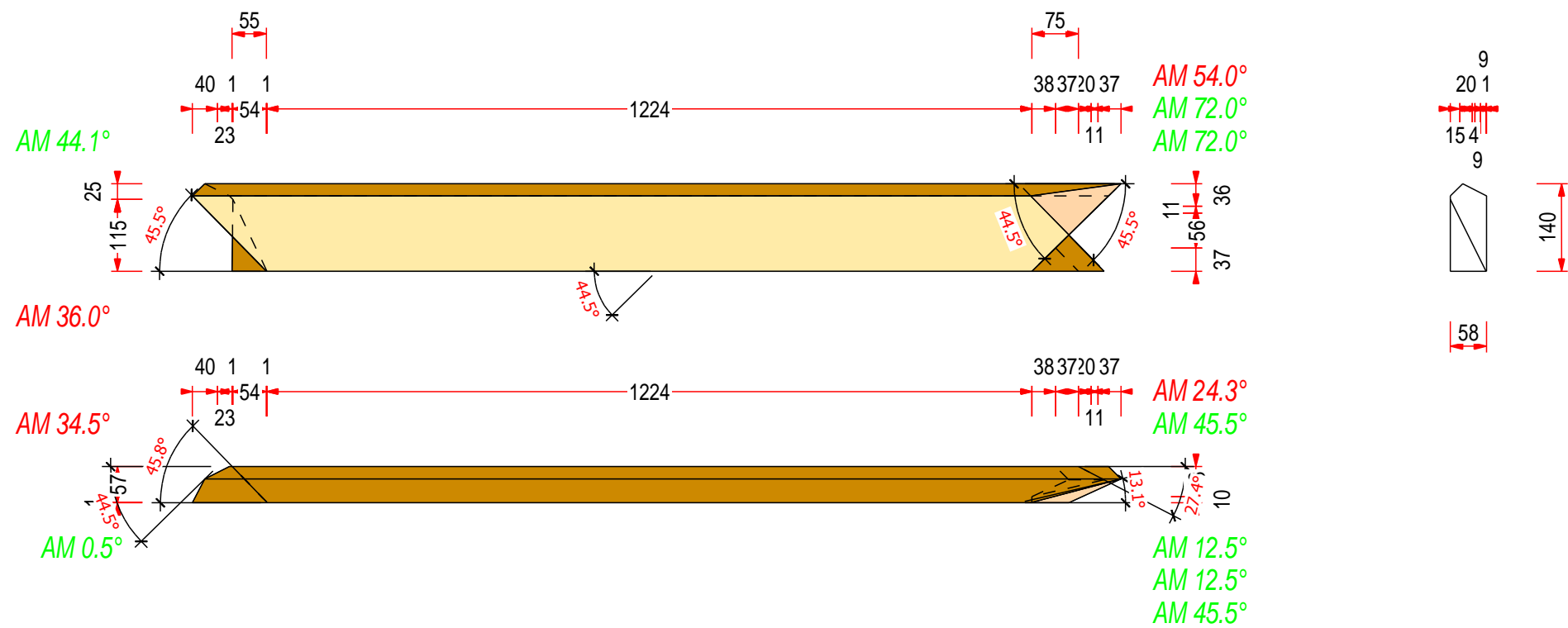

N° LP: **13**

Nom: **Aretier**  
Quantité: **1**

Groupe: Ensemble Epure  
Sous-groupe:

Section: 58mm/140mm  
Longueur: 1486mm  
Matériaux: Sapin

Date: 18.03.2017  
Projet:  
Poids: 5 kg

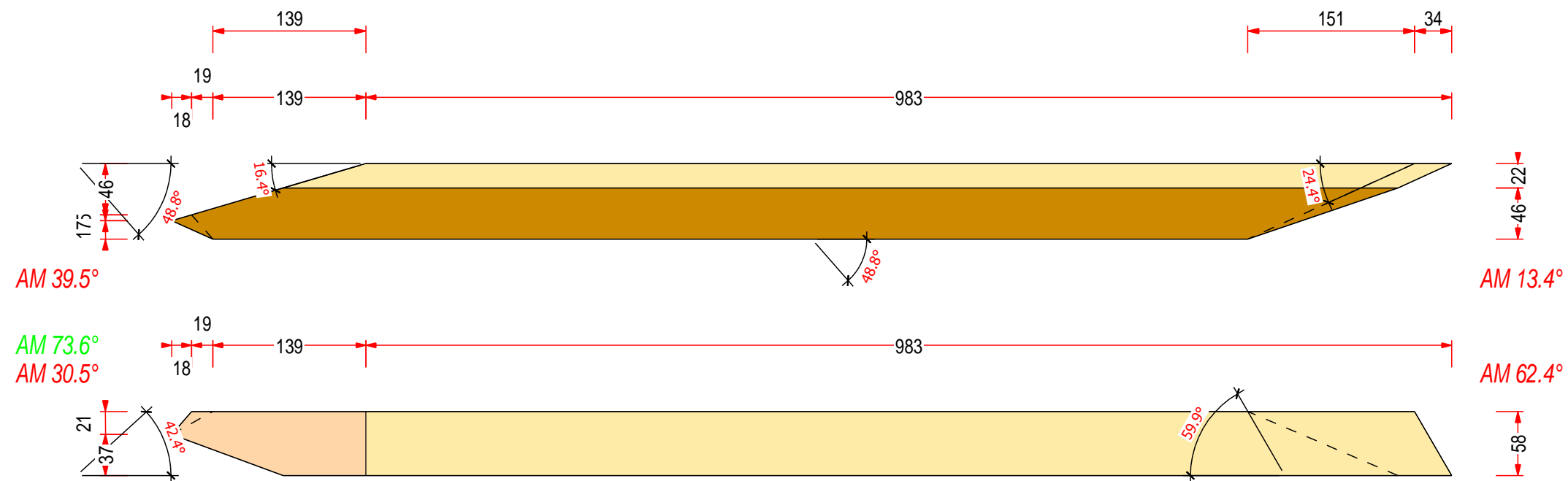

N° LP: **14**

Nom: **Chanlatte**  
Quantité: **1**

Groupe: Ensemble Epure  
Sous-groupe:

Section: 58mm/68mm  
Longueur: 1159mm  
Matériaux: Sapin

Date: 18.03.2017  
Projet:  
Poids: 1 kg

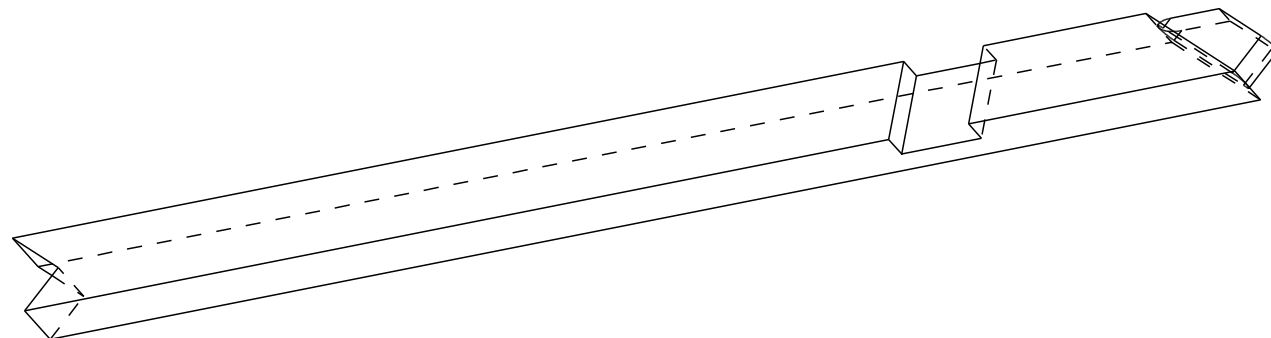
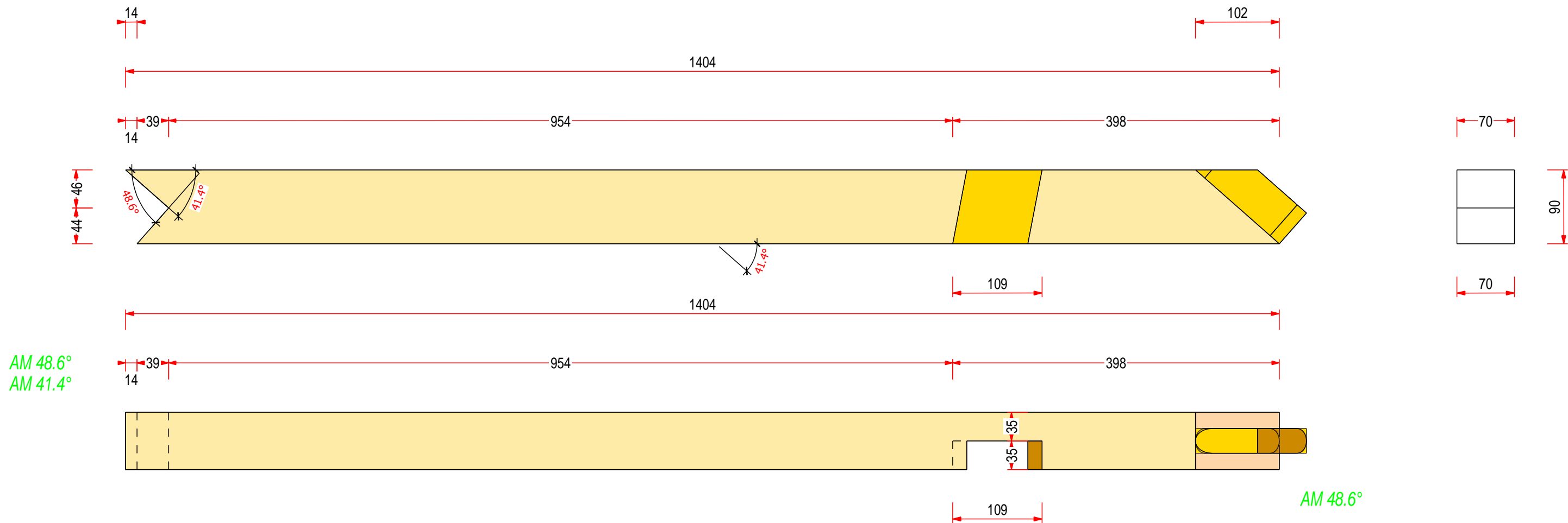

Tenon 1	
tenon-70-40-L	
Forme	rond
Direction	Largeur
Longueur	50mm
Surlongueur	2mm
Largeur	30mm
Surmesure mortaise	1mm
ø perçement	0mm
Ecartement perçage-extrémité	0mm
Décalage perçage	0mm

N° LP: 15

Nom: Arbaletrier  
Quantité: 1

Groupe:  
Sous-groupe:

Section: 70mm/90mm  
Longueur: 1437mm  
Matériaux: Chêne

Date: 18.03.2017  
Projet:  
Poids: 7 kg

caadwork®



Tenon 1

tenon-70-40-L

Forme	rond
Direction	Largeur
Longueur	50mm
Surlongueur	2mm
Largeur	30mm
Surmesure mortaise	1mm
ø percement	0mm
Ecartement perçage-extrémité	0mm
Décalage perçage	0mm

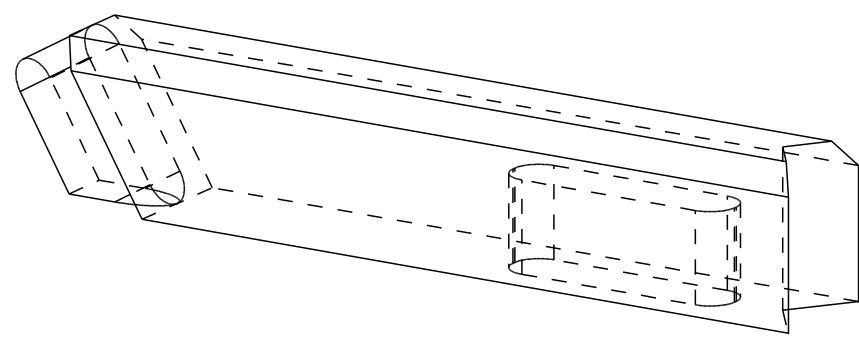
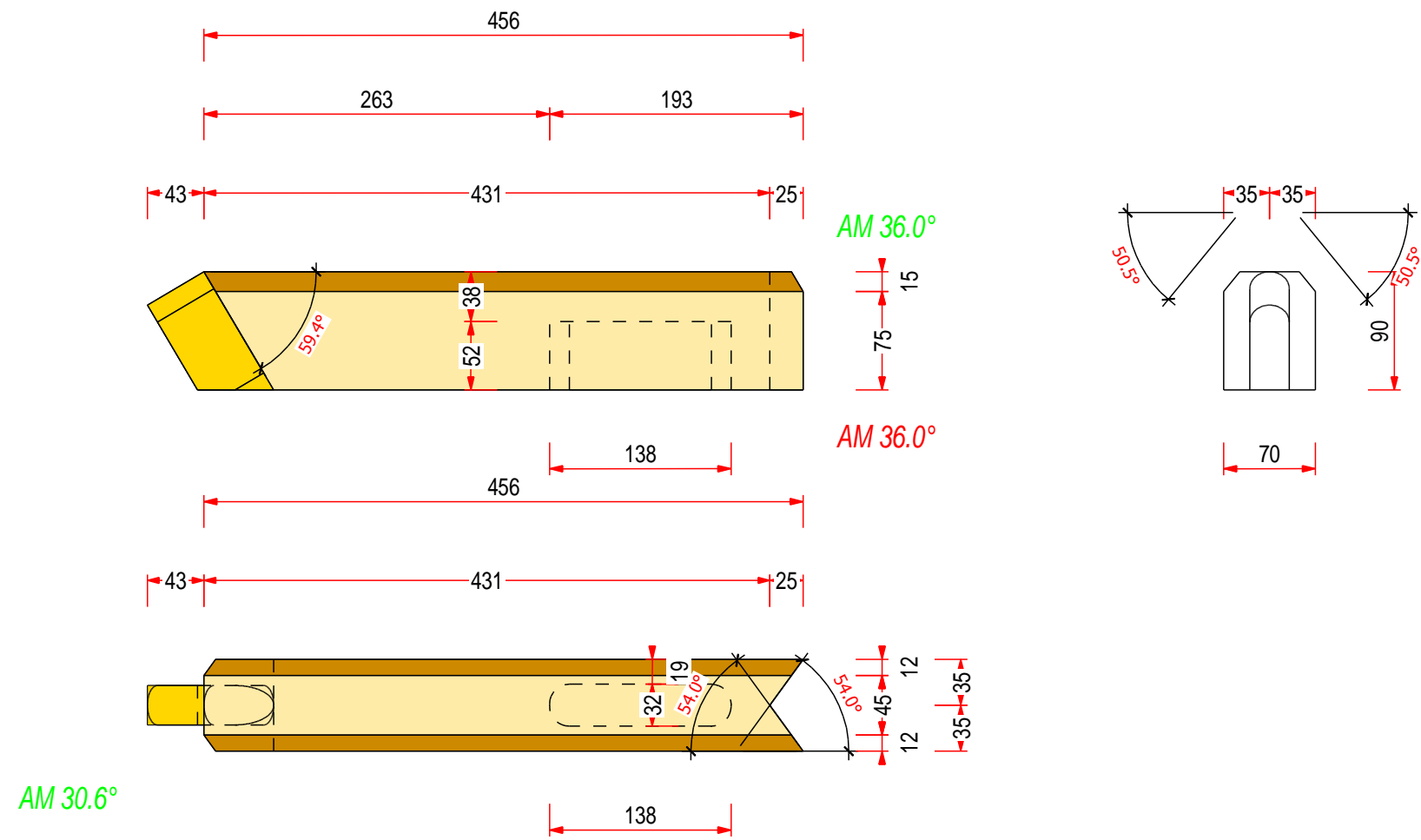

N° LP: **16**

Nom: **Faitiere**  
Quantité: **1**  
Groupe:  
Sous-groupe:

Section: 70mm/90mm  
Longueur: 499mm  
Matériaux: Chêne

Date: 18.03.2017  
Projet:  
Poids: 2 kg

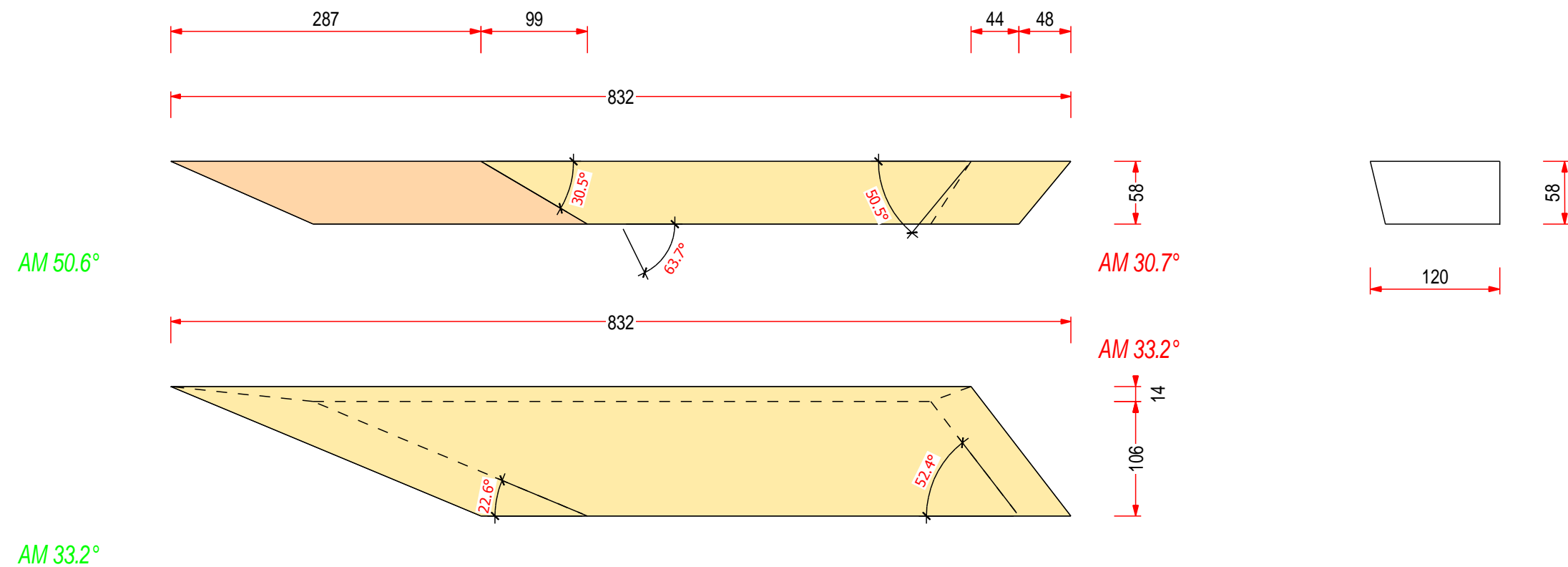

N° LP: **17**

Nom: **Noulet**  
Quantité: **1**

Groupe:  
Sous-groupe:

Section: 120mm/58mm  
Longueur: 832mm  
Matériaux: Sapin

Date: 18.03.2017  
Projet:  
Poids: 2 kg

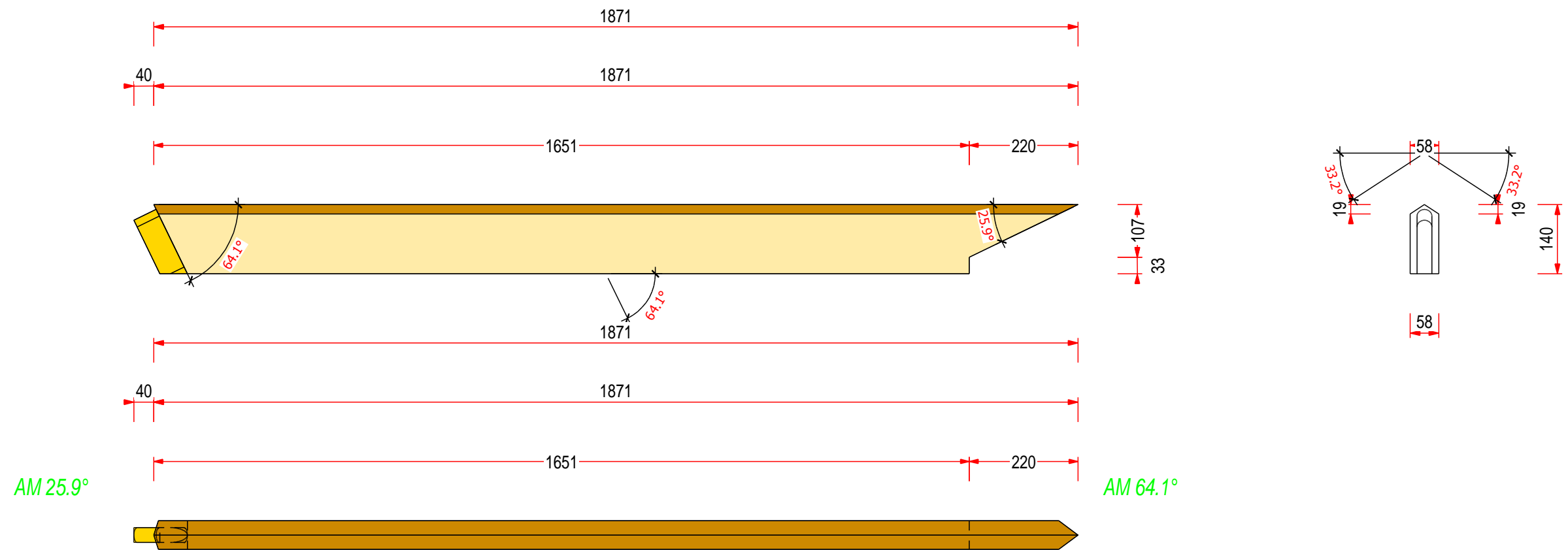

**Tenon 1**

tenon-70-40-L	
Forme	rond
Direction	Largeur
Longueur	50mm
Surlongueur	2mm
Largeur	30mm
Surmesure mortaise	1mm
ø percement	0mm
Ecartement perçage-extrémité	0mm
Décalage perçage	0mm

