

BRIDE COUVERCLE

ANCIEN PROCESSUS

PH 10 TOURNAGE
TOUR CN 2 AXES MAZACK

Usinage des faces : 1, 2, 3, 4, 5, 6, 7

Temps d'usinage = 4 830 min

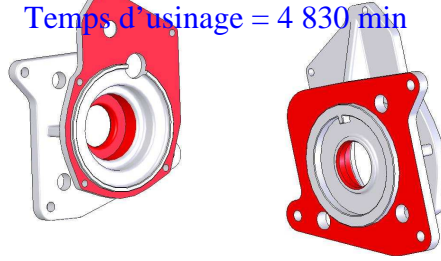

PH 20 FRAISAGE
FRAISEUSE CN 3 AXES GAMBIN

Usinage des faces : 8, 9, 10

Temps d'usinage = 2670 min

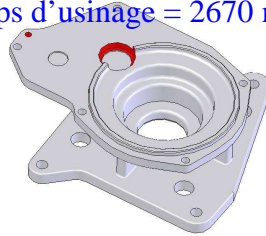

PH 30 EBAVURAGE
PERCEUSE SENSITIVE

Usinage de la face : 11

Temps d'usinage = 5 min

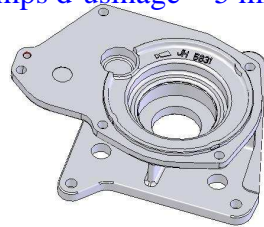

TEMPS TOTAL D'USINAGE

7505 min

NOUVEAU PROCESSUS

PH 10 TOURNAGE
TOUR CN 3 AXES EMCOTURN E65

Usinage des faces : 1, 2, 3, 4, 5, 6,
7, 8, 9, 10

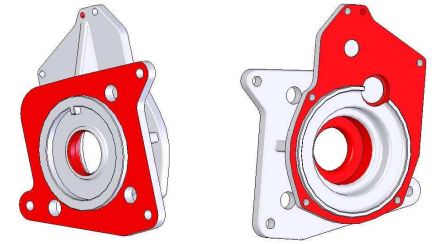

PH 20 EBAVURAGE
PERCEUSE SENSITIVE

Usinage de la face : 11

